



41 The Garners, Rochford, SS4 1DS

**Asking Price £125,000**



# 41 The Garners , Rochford, SS4 1DS

ARE YOU LOOKING FOR A RETIRMENT  
PROPERTY OVER TWO FLOORS?

- Over 55s retirement property- Spread over  
two floors with stairlift - Large 20ft Lounge with  
views over the park and fields - Two double  
bedrooms - Two bathrooms - No onward chain  
- ample communal parking - social room for  
residents to gather - Call us today on 01702  
710 555 to arrange a viewing.



#### Main Entrance

Via communal entrance to ground floor at the front of the building with key fob secure entry system, stairs and lifts to all floors.

#### Communal Areas

As you go through the main doors, to the right hand side you will find a spacious meeting/entertaining room for the residents to enjoy. There are double doors leading outside. There is also a laundry room for residents and the managers office can be found to the left as you come through the main doors.

#### Internal Entrance

There is a private porch area before entering the apartment.

#### Hallway

Wall mounted electric radiator, carpet laid to floor, stairs with stair lift leading to first floor, storage cupboard, doors to accommodation.

#### Lounge

**20'5" x 12'2" (6.22 x 3.71)**

Part of the ceiling is open with wooden beams and window making a fantastic feature, electric fireplace with surround and hearth, windows to side and rear, two wall mounted electric radiators, carpet laid to floor.

#### Kitchen

**8'7" x 8'6" (2.62 x 2.59)**

Matching wall and base units with worktops and inset stainless steel sink and drainer, part tiled walls, space for appliances, window to front, vinyl laid to floor.

#### Bathroom

**8'4" x 6'2" (2.54 x 1.88)**

Fitted with a three piece bathroom comprising a panel bath with shower adaptor, wash hand basin in vanity unit and w/c, window to side, small wall mounted electric heater, tiled walls and vinyl flooring.

#### Dining Room

**13'3" x 9'2" (4.04 x 2.79)**

Window to rear over looking park, carpet laid to floor.

#### Upper Floor

##### Landing

Internal window looking down into lounge, carpet laid to floor, doors to accommodation.

##### Second Bedroom

**13'3" x 9'2" (4.04 x 2.79)**

Wall mounted electric radiator, carpet laid to floor, window to rear over looking park.

##### Primary Bedroom

**14'2" x 11'5" (furthest points) (4.32 x 3.48 (furthest points))**

Windows to rear over looking park, two built in wardrobes, carpet laid to floor, door to...

##### En-Suite Wet Room

**8'5" x 5'5" (2.57 x 1.65)**

Wet room with shower, low level w/c with push button and wash hand basin in vanity unit with mixer tap, window to side, vinyl laid to floor.

#### Agents Notes

- OVER 55s RETIREMENT PROPERTY- AN EXTREMELY SPACIOUS TWO DOUBLE BEDROOM APARTMENT SPREAD OVER TWO FLOORS - 20ft LOUNGE WITH UNIQUE WOODEN BEAM OPEN CEILING - VIEWS OVER THE PARK AND FIELDS - LARGE COMMUNAL MEETING AREA AND LAUNDRY ROOM - CLOSE PROXIMITY TO LOCAL SHOPS - NO ONWARD CHAIN -

## Floor Plan

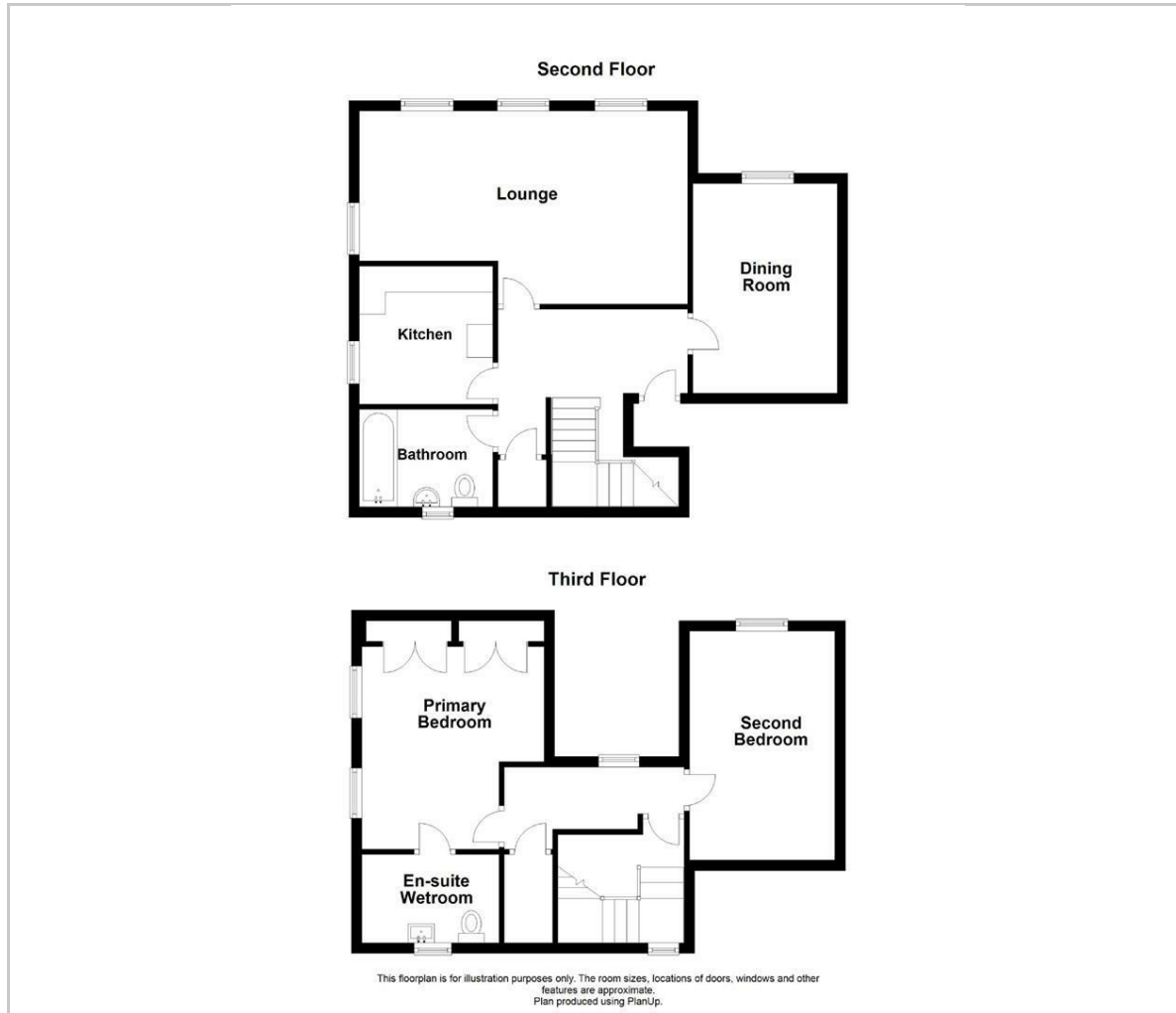

## Area Map

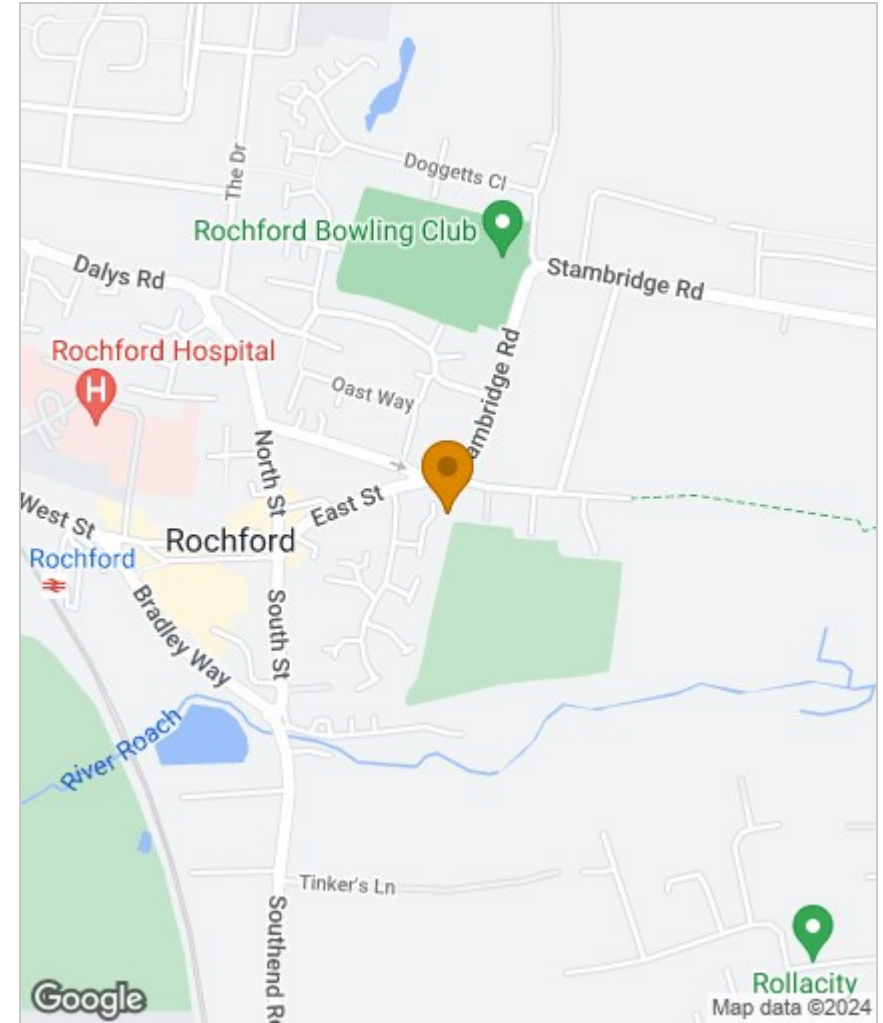

## Viewing

Please contact our Sales & Lettings Office on 01702710555 if you wish to arrange a viewing appointment for this property or require further information.

These particulars, whilst believed to be accurate are set out as a general outline only for guidance and do not constitute any part of an offer or contract. Intending purchasers should not rely on them as statements of representation of fact, but must satisfy themselves by inspection or otherwise as to their accuracy. No person in this firm's employment has the authority to make or give any representation or warranty in respect of the property.



34 Broadway, Leigh-on-Sea, Essex, SS9 1AJ  
Tel: 01702710555 Email: [info@turnerestates.co.uk](mailto:info@turnerestates.co.uk) [turnerestates.co.uk](http://turnerestates.co.uk)